







This drawing is the copyright of Rosetta Landscape Design and cannot be reproduced in any form without the express consent of the company. Written and scaled dimensions to be checked on site, any discrepancies reported prior to work commencing. **If in doubt please ask.**

This drawing has been prepared for the purpose of planning approval.

Planting Notes

Herbicide and cultivation: Topsoil to be treated with two applications of herbicide prior to planting, where necessary, strictly in accordance with the Control of Pesticides Regulations 1986 (as amended 1997, or, otherwise, updated/superseded legislation) and following manufacturer's instructions by qualified staff. The topsoil shall then be cultivated to 150mm depth.
Planting: All planting must be in accordance with BS3336 1992 Nursery Stock and BS 8545 2014 Trees from Nursery to Independence.
Trees: All tree planting should conform to BS5545 2014. Standard trees to be planted in pits 800x600x400mm or dimensions of rootball, whichever is greater. Heavy and Extra Heavy Standard trees to be planted in pits 1000x1000x600mm or dimensions of rootball, whichever is greater. Agrigue soil improver and 150g Esmag (or equivalent) to be incorporated into the soil of all new tree pits. Trees to be planted centrally within a tree pit. Tree stakes shall be of hazel, chestnut or other approved timber. They shall be round, rough sawn, straight, free from projections, large or edge knots and other defects and be pointed at the lower end. They shall be strong enough not to split when driven into the ground and when ties are nailed to them (both initially and when adjusted). For Feathered trees use 20x stakes (1.4m by 75mm) to be driven into ground 800mm, leaving 600mm above ground. For Selected Standard Trees 20x stakes (1.7m by 100mm) and cross bar are required, stakes to be driven 500mm below ground leaving 500mm above ground. For Heavy/Extra heavy trees use 20x stakes (2.2m x 100mm) with a 400x100x5mm cross bar. Stakes to be driven into ground 1m leaving 1.2m above ground.
Tree ties: All tree ties to be Green-Tech Hilditch Natural Tree Ties. Natural tree ties made entirely of natural fibres and is fully biodegradable. A spacer by formed using the Natural tree tie itself. It will not strangle the tree and will biodegrade as the tree establishes itself.
Native Woodland / Shrub areas: Soil depth shall consist of 300mm topsoil and 600mm subsoil (in accordance with BS3362 2015).
Container grown shrubs, transplants and whips: Shrubs and transplants shall be planted in pits 300x300x400mm depth, and the bed soil shall include 3 litres of peat-lite tree and shrub compost. Where two or more shrub species are indicated within a single bed each species shall be randomly mixed throughout the bed in groups of 3/5.
Herbicide: Spot treat with herbicide throughout the maintenance period in accordance with the manufacturer's instructions.
Mulch: Planting beds to receive 75mm depth pulverised ornamental bark mulch. Native woodland / shrub / hedgerow plants to be planted with GreenTech Mulch Mat - Type 11. Mulch Mats are 100% biodegradable with an approximate three year lifespan. Mulch Spats are ready-cut for individual plant production with a centre hole for plant protection. Mats pinned to soil.
Plant position: Final position of trees and shrubs subject to confirmation of service location and approval of statutory undertakers.
Protection to planting: Native hedgerow plants, trees and shrubs within mixes to be protected by Green-Tech Bio-Earth Tree Shelter. The Bio-Earth Tree Shelter is made from a special water-proof FSC-approved cardboard which is 100% biodegradable, recyclable, and compostable. Lifespan is typically 3 years. Once the tree / shrub has established enough to no longer need it, the Bio-Earth Tree Shelter can be left to safely biodegrade.
Planting Season: Bare-root shrubs to be planted between mid-November and mid-March dependent upon the planting season.

LEGEND

-  Application boundary
-  Ownership boundary
-  Existing vegetation
-  Proposed tree Heavy (Standard)
-  Proposed tree (Standard)
-  Proposed Native Woodland Mix

Rev A: Revised to Ecologist comments - 23May 23 (BP)
 Base: Wardman Brown 'Site Location Plan' L022143-001 received 15May 23

PROJECT	Calf Fallow Lane, Stockton on Tees		
TITLE	Detailed Landscape Proposals		
CLIENT	Georgia Swales		
DATE	16 May 23	SCALE 1:200	SHEET A1
DRAWN	BP	DRAWING NO	3994/I
CHECKED	BP	REVISION	A



Sawlow's Nest, Main Street
 Ashham Richard, York, YO23 3PT
 Telephone +44 (0)1964 500410
 Email design@rosettalandscape.co.uk
 Web www.rosettalandscape.co.uk

Planting Schedule

Proposed Trees					
Nr	Code	Tree Name	Specification	Grth	Height
2	Qp	Quercus petraea	Heavy Standard / Clear Stem 175-200 RB	12-14cm	350-425cm
Total 2 -					

Proposed Conifers					
Nr	Code	Tree Name	Specification	Grth	Height
6	Pf17	Pinus sylvestris	Standard	8-10cm	150-175cm
Total 6 -					

Native Woodland Mix (0.25m ²)					
Nr	Code	Plant Name	Root	%	
61	Ac	Acer campestre	Whip	BR	20%
61	Ag1	Aglus glutinosa	Whip	BR	10%
61	Bp	Betula pendula	Whip	BR	20%
31	Cav	Corylus avellana			10%
31	Crn	Crataegus monogyna	Whip	BR	10%
16	Pa	Prunus avium	Whip	BR	5%
16	Pp	Prunus padus	Whip	BR	5%
31	Qr	Quercus robur	Whip	BR	10%
31	Sau	Sorbus aucuparia	Whip	BR	10%
Total 309 -					

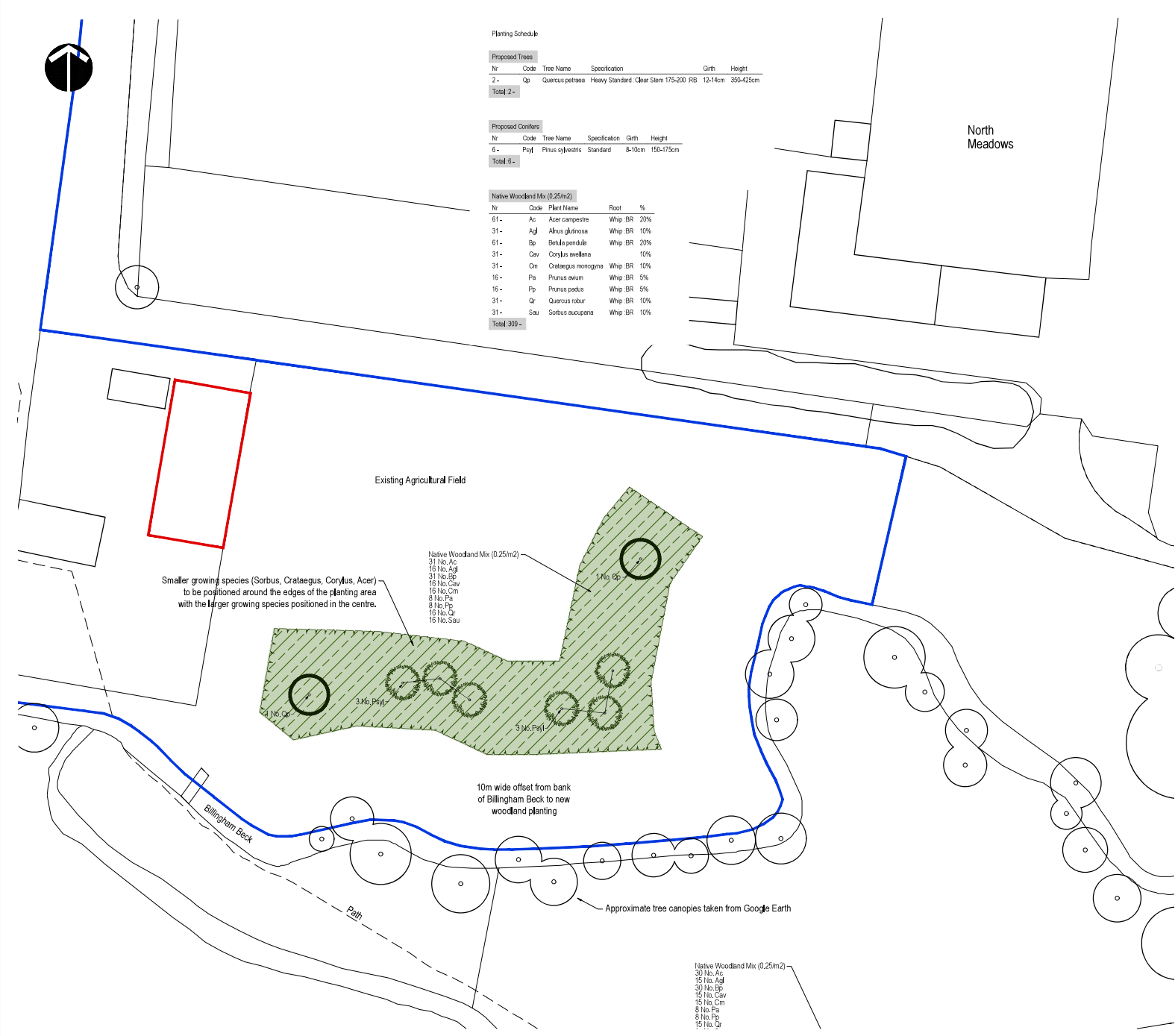

Native Woodland Mix (0.25m ²)					
Nr	Code	Plant Name	Root	%	
30	No.Ac				
15	No.Ag1				
30	No.Bp				
15	No.Cav				
15	No.Crn				
8	No.Pa				
8	No.Pp				
15	No.Qr				