

AGENDA ITEM

REPORT TO CABINET

8 MARCH 2012

**REPORT OF CORPORATE
MANAGEMENT TEAM**

CABINET DECISION

Arts, Leisure & Culture – Lead Cabinet Member – Cllr Dixon

PRESTON HALL MUSEUM & PARK UPDATE

1. Summary

As part of the ongoing redevelopment of Preston Hall Museum & Park, Preston Hall Museum is currently closed to the public to enable the final phase of a major capital investment programme to restore and improve the Grade II listed building and the services it provides. This important project, funded through a variety of sources including a £3.581million Heritage Lottery Fund grant, forms the centrepiece of Stockton Borough Council's Heritage Strategy, and will further cement the position of Preston Hall Museum & Park as a major visitor attraction within the Tees Valley. The project includes a rationalisation and re-housing of the Museum's collections in purpose built stores, the creation of new Learning and Craft resources, a complete refurbishment and redisplay within the main museum building, and improvements to the popular Victorian Street.

In addition to this, further works, as identified through the 2008 Preston Hall Museum & Park Masterplan are currently being implemented. These include a recently completed £500k capital funding programme through Stockton Borough Council to provide improvements to park infrastructure including drainage works, creation and improvement of pathways and the installation of a new jetty. In addition to this, further success through the Heritage Lottery Fund has resulted in the restoration and re-interpretation of the Walled Kitchen Garden & Orchard, forming a physical link between hall and park.

The final stages of the work in the main museum building are currently under way, with case and display installation planned for completion by late May. Work to populate exhibition displays with the collection will take place during June, as will staff training and development. The Museum is projected to re-open to the public during the Summer of 2012 with a full programme of activities and events to attract visitors to the new facility including two theatrical performances in the park, special exhibitions and a wide range of learning opportunities. An official opening, aiming to attract significant media attention, is still to be scheduled.

The project has been supported by local stakeholders through the Preston Hall and Park Management committee which has incorporated work being undertaken through the Tees Heritage Park initiative.

2. Recommendations

1. To note the progress on Hall works, with reference to the displays, collections work, future trading opportunities and heritage branding style.
2. To approve initial plans for the reopening of Preston Hall.
3. To support the statement that Stockton Borough Council is committed to ensuring Preston Hall Museum & Park remains as a key visitor attraction, protected by the listed status of the Hall and the undertakings of the Green Infrastructure Strategy and Core Strategy Development Plan.

3. Reasons for Recommendations

To ensure the continued development of Preston Hall and Park meets corporate strategic priorities and the expectations of Stockton Communities. To optimise the potential benefits arising from the investment of the hall through appropriate re-opening and launch activities.

4. Members' Interests

Members (including co-opted Members with voting rights) should consider whether they have a personal interest in the item as defined in the Council's code of conduct (**paragraph 8**) and, if so, declare the existence and nature of that interest in accordance with paragraph 9 of the code.

Where a Member regards him/herself as having a personal interest in the item, he/she must then consider whether that interest is one which a member of the public, with knowledge of the relevant facts, would reasonably regard as so significant that it is likely to prejudice the Member's judgement of the public interest (**paragraphs 10 and 11 of the code of conduct**).

A Member with a prejudicial interest in any matter must withdraw from the room where the meeting considering the business is being held -

- in a case where the Member is attending a meeting (including a meeting of a select committee) but only for the purpose of making representations, answering questions or giving evidence, provided the public are also allowed to attend the meeting for the same purpose whether under statutory right or otherwise, immediately after making representations, answering questions or giving evidence as the case may be;
- in any other case, whenever it becomes apparent that the business is being considered at the meeting;

and must not exercise executive functions in relation to the matter and not seek improperly to influence the decision about the matter (**paragraph 12 of the Code**).

Further to the above, it should be noted that any Member attending a meeting of Cabinet, Select Committee etc; whether or not they are a Member of the Cabinet or Select Committee concerned, must declare any personal interest which they have in the business being considered at the meeting (unless the interest arises solely from the Member's membership of, or position of control or management on any other body to which the Member was appointed or nominated by the Council, or on any other body exercising functions of a public nature, when the interest only needs to be declared if and when the Member speaks on the matter), and if their interest is prejudicial, they must also leave the meeting room, subject to and in accordance with the provisions referred to above.

AGENDA ITEM

REPORT TO CABINET

8 MARCH 2012

**REPORT OF CORPORATE
MANAGEMENT TEAM**

CABINET DECISION

Arts, Leisure & Culture – Lead Cabinet Member – Cllr Dixon

PRESTON HALL MUSEUM & PARK UPDATE

SUMMARY

As part of the ongoing redevelopment of Preston Hall Museum & Park, Preston Hall Museum is currently closed to the public to enable the final phase of a major capital investment programme to restore and improve the Grade II listed building and the services it provides. This important project, funded through a variety of sources including a £3.581million Heritage Lottery Fund grant, forms the centrepiece of Stockton Borough Council's Heritage Strategy, and will further cement the position of Preston Hall Museum & Park as a major visitor attraction within the Tees Valley. The project includes a rationalisation and re-housing of the Museum's collections in purpose built stores, the creation of new Learning and Craft resources, a complete refurbishment and redisplay within the main museum building, and improvements to the popular Victorian Street.

In addition to this, further works, as identified through the 2008 Preston Hall Museum & Park Masterplan are currently being implemented. These include a recently completed £500k capital funding programme through Stockton Borough Council to provide improvements to park infrastructure including drainage works, creation and improvement of pathways and the installation of a new jetty. In addition to this, further success through the Heritage Lottery Fund has resulted in the restoration and re-interpretation of the Walled Kitchen Garden & Orchard, forming a physical link between hall and park.

The final stages of the work in the main museum building are currently under way, with case and display installation planned for completion by late May. Work to populate exhibition displays with the collection will take place during June, as will staff training and development. The Museum is projected to re-open to the public during the Summer of 2012 with a full programme of activities and events to attract visitors to the new facility including two theatrical performances in the park, special exhibitions and a wide range of learning opportunities. An official opening, aiming to attract significant media attention, is still to be scheduled.

The project has been supported by local stakeholders through the Preston Hall and Park Management committee which has incorporated work being undertaken through the Tees Heritage Park initiative.

RECOMMENDATIONS

1. To note the progress on Hall works, with reference to the displays, collections work, future trading opportunities and heritage branding style.
2. To approve initial plans for the reopening of Preston Hall.
3. To support the statement that Stockton Borough Council is committed to ensuring Preston Hall Museum & Park remains as a key visitor attraction, protected by the listed status of the Hall and the undertakings of the Green Infrastructure Strategy and Core Strategy Development Plan.

DETAIL

Introduction

1. Preston Hall & Park is a valued community greenspace occupying an area of c100 acres of parkland around the Grade II listed building.
2. Preston Hall was built by local solicitor David Burton Fowler in 1825 as a sober gentleman's residence, set in woodland alongside the River Tees. It was not until the 1880's however, that the building and landscape that we see today was developed. This was the work of Robert Ropner, a German immigrant who, through judicious investment and business acumen, rose to become an extremely successful ship builder and one of Stockton's most celebrated figures.
3. Ropner required an estate which befitted his status, and so set about transforming an inconspicuous late Georgian site alongside the river Tees into a fashionable Victorian demesne. Substantial alterations to the Hall included a Ballroom, Winter Garden and Billiard Room. The landscape benefitted from walkways, a carriage drive and the framing of all- important views out to the river and the Tees landscape beyond.
4. The 20th Century has seen a number of alterations to the site. Preston Hall & Park was sold by the Ropner estate in 1937, and for the next ten years went through a variety of uses. The Hall and its surrounding lands were purchased by Stockton Corporation in 1947, and developed into a museum and public park.
5. Since 2009, the Hall itself has been subject to a major redevelopment split into three phases. The initial phases focused on the construction of a number of new build structures, whilst the most recent and most extensive has been centred on the main building, with many of the original features being restored and refurbished.
6. The surrounding parkland, although benefitting from a number of improvements has suffered historically from a loss of its relationship with the wider Tees landscape, through removal of wooded areas and simplification of the site. Bids have been submitted to the Landscape Partnership Scheme with the ultimate aim of restoring historical elements of the parks landscape, including planting of appropriate species in an informal Victorian setting.

Park Works

7. The Park is a major events venue for Stockton Borough Council, and also provides for a range of year round leisure activities, from children's play to dog walking. The Park attracts approximately 400,000 visitors a year.
8. Thanks to the provision of £500,000 Stockton Borough Council capital funding, a number of areas were identified for attention in the Park. Access to the Park via Yarm Road is now much easier due to the through traffic signalling system. In one of the first completed projects (Jan 2010), the inclusion of designated traffic lights and a pedestrian crossing at the main Yarm Road entrance has substantially decreased the traffic congestion for general access. The improvement is especially apparent for major events and busy weekends.
9. An independently metered gas supply to the privately run Butterfly World attraction has also been installed.
10. On the riverside, a new river access pathway now links the Hall to a jetty structure, increasing accessibility from river to Park. The pathway has provided a valuable and aesthetically pleasing link between the river and the heart of the Park. A resin bound stone chip treatment ensures that the surface is anti-slip, whilst benches provide resting points or an opportunity to take in the view. (Appendix 1 image 1)
11. Officially launched in April 2011, the jetty structure improves access for a wide variety of craft including canoes, boats and pleasure cruisers. (Appendix 1 image 2)

12. The improvements to the riverside area form part of the wider Tees Heritage Park initiative. In addition to the new and improved footpaths, as part of the linking process for the project, there will be rest areas and new "gateways". Five appropriate "sculptures" are to be created close to the gateways. It is widely recognised that Preston Hall and Park, being geographically central to the Tees Heritage Park and providing a complementary offer through its social heritage exhibitions and interpretation, provides the hub for the Heritage Park offer. The parkland and vantage points towards the river offer panoramic views, providing a sense of place. The Preston Hall Gateway sculpture will be installed in this context, taking advantage of the river views on the newly installed pathway. Work has already begun on site to create the installation which has been designed with involvement from local schoolchildren and residents. (Appendix 1 image 3)
13. The connection with the wider Heritage Park and communities from the south of the River would be enhanced by the creation of either a ferry crossing service or a footbridge within the Park. A full and detailed feasibility for a new river crossing on the site will be undertaken in the future, subject to the availability of funding.
14. To the rear of the Hall complex, a new vehicular access route from Preston Lane to the main Hall and Park has been opened (completed in Summer 2010). Carried out in tandem with the Phase I & II works on the Hall, the rear service access now provides a direct link for staff and deliveries from Preston Lane to the main Park, significantly reducing traffic on the main carriage drive. The work includes high level speed bumps to ensure safety at all times
15. Completed in time for the Summer season 2010, the event field drainage has made a marked difference to the area. Previously holding water up to 4" above soil level, the ground now drains away quickly and evenly thanks to a wide network of herringbone channels and linked soakaways.
16. A new dedicated cycleway running through the site has improved access for cyclists and improving cycle access throughout the area. The newly created route follows on from Queen Elizabeth Way, through the Park and meets up with the current Yarm Road cycle pathway. The pathway was completed in Summer 2011.
17. In the area close to the main car park, a new play facility has been developed. Situated on the site of the former animal pens, the cost of £200,000 was realised from a number of funding sources, including the national Playbuilder scheme and Stockton Borough Council. Work began in May 2010, and was completed in Summer 2011. The finished works include a wide range of challenging and interactive play, centred around the existing trees on the site and contain aerial ropeways, sky cabins and challenge nets. (Appendix 1 image 4&5)

Hall Redevelopment Project

18. Work at the Hall has fallen into three phases with the first two running concurrently between October 2009 and July 2010, one phase based around a new build and the other around refurbishment of existing buildings. Phase 1 of the project saw the creation of a purpose built store housing the Museum Service collection in a single location. The Spence Building, or Collections Store, now houses a wide range of the Museums Collection with dedicated storage for areas such as costume, porcelain and social history. A secure area provides separate housing for weaponry, fine art and objet de vertu. The building also provides office space for Collections staff and volunteer support (Appendix 1 image 6&7)
19. At the same time a dedicated Craft Resource building, providing working accommodation for craftspeople, demonstrators and community groups was created in the area adjacent to the Victorian Street, in a period courtyard setting. Containing a unique multi-use blacksmithing group forge, the resource also provides facilities including staff rooms and toilet. (Appendix 1 image 8&9)
20. Alongside this work, Phase 2 provided new staff offices and fully equipped meeting room, staff area and changing facilities for costumed interpreters at first floor level. On the ground floor a Collections Access suite has been created, giving visitors the opportunity to explore

historical records, archives and the wider museum collection. To complement this a Learning Resource, with two separate education spaces, has been developed and both are fully equipped with wet/dry areas and audiovisual technology. To complete this work, the existing toilet facilities within the Victorian Street have been updated and refurbished providing independent disabled and nappy changing areas. (Appendix 1 images 10-15)

21. Phase 3 of the works has been running since May of 2011 and this has seen the restoration of the Grade II listed Hall, including replacement of original features and removal of interim additions. The work has also included the improvement of accessibility throughout the building and simplified orientation. The final element of this phase of the project is the redisplay of the Museum collection, incorporating a wide range of previously unseen objects (Appendix 1 images 16-19).
22. Work began in May 2011 with appointed main contractor Quarmby Construction and exhibition design and fit-out specialists RS Displays Ltd working in partnership with SBC Technical Services and conservation architects Buttress Fuller Alsop Williams, providing the team for the restoration and refurbishment of the Grade II listed Hall, improvement of building access and the redisplay of the Museum collection. Layouts for both ground and first floor of the newly developed museum incorporate a completely revised orientation upon entering the building. New facilities and spaces have been created including lifts, temporary galleries and a function suite. Previously redundant spaces have been brought into use. See Appendix 2.
23. On entering the Hall, visitors will see a new Reception and Shop area which will provide a bright, modern welcome for visitors, setting the scene for the new Museum experience. A wider range of quality retail items will be on sale in the shop and these will reflect the collections and the activities of the Museum.



24. On the ground floor the gallery spaces' individual themes will draw the visitor in. The displays will focus on 'The Hall & Its People' with background information on the history of the building, the surrounding parkland and the Ropner family.



25. The exhibitions have been completely redesigned and will allow a far better presentation of a wider selection of items from our collections including weaponry from the Spence Bequest, paintings from the Clephan Bequest, the Ions collection of fine porcelain and a selection of silverware from the local area.

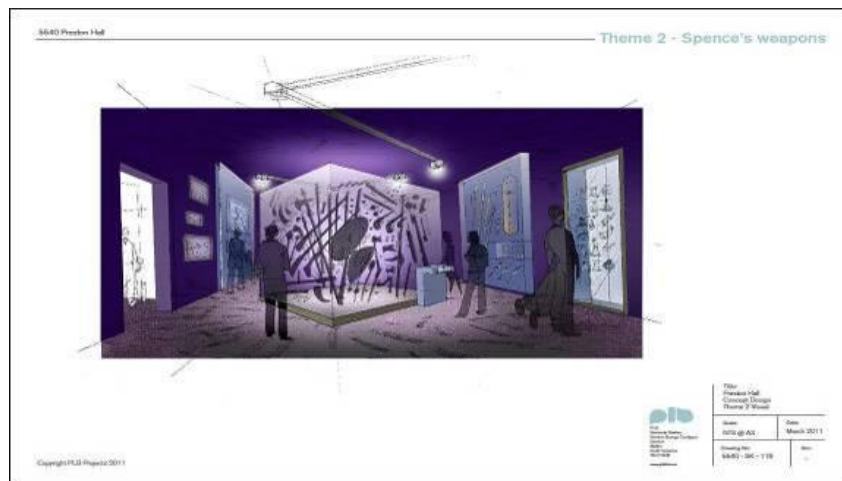

26. Rooms have been redesigned and reformatted to ensure that they are completely accessible and offer security to the objects in the collection. Three new lifts and accessible toilets have been installed within the building and an area has been created in which the Station Clock from Stockton will be displayed as a feature, at the entrance to the Victorian Street.

27. In addition to this, the former Ballroom and Ante-room have been completely refurbished and will form the centre piece of Preston Hall's hospitality offer. The newly renamed Music Room and Billiard Room along with the Winter Garden, will be available for a range of ceremonies and celebrations, as well as conferences and community events. The Music Room holds 100 people and will contain a full range of audiovisual equipment, in addition to an independent servery and catering facility.

28. Trade and industry feature strongly in the first floor galleries, with themes centred around the River Tees and its influence on the Borough of today. Displays concentrate on the shipping and chemical industries including a number of ship models and items of industrial heritage from the collection of the museum. The importance of the Stockton and Darlington railway will be highlighted in this area of the museum and the view across the park towards the historic trackbed will be a feature of this interpretation. As visitors make their way through the upper floor, they will move from the industrial and riverside displays into an area which focuses on home life for local residents, with displays relating to pastimes and activities entitled "Clocking off".



29. The visitor will conclude their journey by descending into the Victorian Street at the end of the sequence of community focused rooms. A separate space on this level, funded by the Esme Fairbairn Foundation, will form a demonstration kitchen, providing the opportunity for visitors to take part in food and cookery workshops. It is intended to use produce from the restored Kitchen Garden in these activities.
30. A community curated space has been developed on the first floor of the Museum and this will allow temporary exhibitions of items, memorabilia and art work developed through community projects or involvement. Two further spaces have been brought back into use having been previously used as offices and these will house temporary exhibitions in an attractive location overlooking the Park.
31. On the main staircase, work is continuing to uncover original glass and skylights to bring more natural light into the building. In other areas of the entrance hall similar work to upgrade and restore glass and original features to bring the building back to its original state are continuing.

Progress on the works

32. The refurbishment works are progressing well. The Museum closed on September 5th 2011 having been open across the Summer with a temporary exhibition entitled "Behind the Scenes" at the Museum, located in the Ballroom. The Victorian Street was also open to the public during the Summer Season, with a temporary tea room and shop facility offered in the former Drapers concession. Visitor figures for the period were very positive, with over 86,200 visits recorded for the season between February and September 2011 (Appendix 1 image 20-22)
33. The main part of the work to the Hall began in October and has continued throughout the Winter period. Work on the exterior of the building has taken place to restore original features such as carved stone details, restoration of stone work and replacement of skylights. This work is now in its final stages
34. Inside the building, all rooms have been rewired, a new heating system is now in place and new fire and security alarms have been fitted to the building. The first floor rooms are now almost complete and have been rearranged into their final layout.
35. On the ground floor there is some work still to do to the main galleries and to the Winter Gardens prior to the refitting of cases and display units. The Museum's new showcases and display fittings are currently being constructed and should be on site and ready to be filled in May. The final arrangements for the displays are in place and an enormous amount of work has taken place by both paid staff and volunteers to clean, record and preserve the thousands of objects which will be exhibited.
36. The Music Room and Billiard room are currently being repainted in their new Pugin-inspired tones of rich red, blue and gold. The original parquet floors and pitch pine floors have been retained and restored in parts of the building where deemed appropriate. Dry rot in some areas of the 20th C mahogany panelling has been treated and where necessary, panels have been replaced.
37. The final works to the Victorian Street will be completed by the end of June, with the relaying of the cobbled surface within the Upper Street providing not only a more accessible routeway for visitors, but also allowing installation of underground pipework and cabling to the basements area. In the basement itself, work has been undertaken to drain the formerly flooded access points, whilst removing asbestos from the building.

Walled Kitchen Garden & Orchard Project

38. Thanks to funding from Heritage Lottery Fund supported by SBC, the confirmation of a £370k bid in April 2011 has allowed the redevelopment of the former Walled Kitchen Garden and Orchard. Due for completion in Summer 2012, the area will contain glasshouses, restored features and support a wide range of horticultural activities. (Appendix 1 image 23&24)

39. Work on the site has now commenced with the initial clearance of the area having begun with volunteer assistance and the Shaw Trust who will assist in the future to ensure that the project is sustainable. An area of land towards the rear of the site is being made available to the Trust to assist with training and skills development for volunteers. A Senior Gardener will join the team over the next few weeks to oversee the project for the first three years and we will continue to work with our partners to ensure sustainability for this element of the project.
40. Landscaping, building work and the replacement of the Vine Houses in their original position is currently being undertaken by the main contractors for the Hall project, Quarmby Construction. Timed to reopen in tandem with the main hall, the newly developed area will double the footprint of the museum experience, and provide a valuable link between the former disparate elements of hall and park. Space within this rear area has also been allocated for the creation of a small Industrial Zone, celebrating the history of some of Stockton's major past industries. The stars of this will be the former Browns Foundry Gantry Steam crane and lathe, both set for consolidation and conservation over the forthcoming months.

Future Retail and Trading at Preston Park

41. The refurbished Hall and Park offer the Borough a real potential in generating additional income to assist with the development and delivery of a major heritage attraction for the Tees Valley. To reflect the improved and extended offer at the Museum, an increase will be made to the charging structure for entrance, but the annual ticket option will be retained to encourage repeat visits.
42. The suite of public rooms created during the refurbishment process has been designed particularly with weddings and conferences in mind. A clearly defined relationship with Registrars has reviewed the costs of providing the wedding venue, whilst also clarifying those dates available for booking. The Music Room will provide seating for up to a hundred guests for either wedding or meeting purposes. Audio Visual project and sound systems will allow for presentations or music to accompany ceremonies, whilst the provision of 'bolt on' services such as pianist, harpist, fresh flowers and a champagne and canapé welcome will provide a more cohesive offer to the public. Booking for ceremonies is building up, with 42 bookings already taken for the period September – December 2012.
43. The increasingly successful ParkMadz identity covers a range of craft activities, demonstrations and products inspired by the landscape of the park. A range of ParkMadz courses will be offered through the Craft resource area of the Museum. These will be offered by local craftspeople with a percentage of the fees being retained by the Museum. ParkMadz souvenirs and product made by craftspeople will also be on sale in the Museum Shop and there will be 20% commission on these items. The range will include stained glass, woodwork, pottery and items from the blacksmiths.
44. Watson & Brigham Tearoom & Terrace will be opened in the former drapers shop on the Victorian Street as a traditional Victorian visitor experience. The temporary Tea Room which was offered during the Summer season of 2011 was very popular with visitors and this has been incorporated into the plans for the refurbished street. Watson & Brigham will use trained costumed staff to serve a simple menu which focuses on traditional morning coffees and afternoon teas, and where possible, will utilise produce from the Kitchen Garden. It is proposed that the catering will be provided by the Council's own direct services arm, Tees Cuisine. The facility will be available to both museum visitors and, through a separate access via a newly created stone terrace area at the rear of the building, to park visitors.
45. The Museum shop will be an integral part of the retail operation at Preston Hall. Items on sale will be carefully chosen to reflect the collections and the content of the exhibition, and wider park structure. Discussions have been taking place as to the feasibility of selling higher cost items such as framed prints of local images using the photographic collections

held by the Borough. Items from the Museum's *Park Madz* collections will also be included where possible. A standard 15% fee will be applied to sales through retail outlets such as the shops on the Victorian Street and independent blacksmithing courses offered in the Forge.

46. Discussions are ongoing with the Communications team to develop promotional and marketing material for Preston Hall Museum & Park which conveys the heritage focus of the Hall and its setting whilst also suggesting the wide appeal of the Park and its events. Promotional material will also need to highlight the ownership and support of Stockton Borough Council.

The reopening of the Museum.

47. The Museum is expected to open its doors in early July 2012, and a range of activities is planned for the summer season to promote the new attraction. Although the reopening will stimulate significant local interest, it is proposed that the celebrations be focused on attracting local visitors over the summer period, rather than regional or national media interest.
48. The summer of 2012 will be a challenging period in which to attract any media coverage because of the massive programme of events associated with the Diamond Jubilee and the London 2012 Olympic and Paralympic Games. The period will also be one of intense pressure on staff across the Council who are associated with culture, leisure, and events. It is proposed therefore that the opening seasons serve as a soft launch or extended preview period before a formal, high profile event in late 2012 or early 2013.
49. The site is proposed to re-open to the public on Sunday July 1st with the annual ParkMade Live! event providing a range activities within the hall and park. A preview launch might still involve the Mayor, Civic dignitaries and Lead Members despite the intention to stage a later formal opening. As the work has included a huge contribution from the Museum's volunteer workforce, it is proposed that the preview launch be used to thank all those involved. The launch would provide the opportunity for a Victorian theme using the Costumed interpreters who will be bringing life and animation to the new facilities.
50. Throughout the summer season, there are a number of events which will be taking place both inside the Hall and on the events field. Regular activities will be taking place for children and families on Wednesdays and Fridays whilst *ParkMadz* courses and taster days will be offered on weekends from the 1st July. There are two outdoor theatre productions taking place – *The Twits*, by Roald Dahl will be performed on July 27th and *Private Lives* by Noel Coward will be performed on August 31st. Events and activities to linked to the London 2012 Games are also included in the programme.

Future continuity and sustainability for the Hall and Park

51. The Council approved a master plan for Preston Park in June 2007 which was developed through a Select Committee Scrutiny of the Park and Hall. The 2007 plan set out how the original parkland setting for the Hall might be reinstated whilst retaining the broad appeal of events and attractions in the Park. Complementary bids for Hall works and Park works were then made to Heritage Lottery Main Programme and Parks for People respectively. The Hall bid was successful but the Park bid was not. However, the key features of the master plan relating to the Park have continued to drive and shape development of the site.
52. In response to the national Building Schools for the Future Programme, exploring all options for the south of the Borough, Stockton Borough Council was obliged to evaluate the technical viability of Preston Park as a potential secondary school site. However theoretical or unlikely such an exploration might have proven, there was a considerable public objection, and there remains a nervousness in some communities that Stockton Borough Council may not adequately protect the Park against future inappropriate development.
53. The Friends of Protect Preston (formerly the Protect Preston Park group) have continued to press for the long term future of the Park to be secured, either by placing a legal restriction

on the use of the land, or by transferring it to a Trust body created solely to oversee the running of the Park and Hall. The Friends of Preston Park (FoPP) recently submitted to the Council a Vision for the Park in which they outlined their concerns and aspirations.

54. In November 2011, the Park Management Group, incorporating Council Officers, local Councillors, the Chair of the FoPP, private traders, and voluntary groups operating in the Park, considered the Vision document at length. It was agreed by all, and acknowledged by the FoPP, that the Vision largely reflected the declared priorities of the Council in relation to the Park, and the programmes of work already underway. Sensitive developments, such as the extension of the play facilities, reinstatement of the Kitchen garden, interpretation of heritage within the landscape and improvements to paths, signage and access, remain at the heart of all parties' plans. A commitment to the achievement of the Green Flag status for the Park has also been discussed with the FoPP.
55. Stockton Borough Council is committed to ensuring Preston Hall Museum & Park remains as a key visitor attraction in the Borough and a gateway to the wider Heritage Park. The listed status of the Hall already extends legally binding restrictions to any changes to its landscape setting. Furthermore, the role of the Park as a gateway to the larger Heritage Park is also reflected in our Green Infrastructure Strategy and in the Core Strategy Development Plan Document (DPD).
56. The Core Strategy DPD forms the overarching policy framework for the Borough and policies within the other DPDs scheduled as part of the Local Development Framework will expand on the policies in the Core Strategy including the importance and protection of the Hall and Park.
57. In the long term Stockton Borough Council aims to realise the key features of the 2007 masterplan, improving the whole Park and strengthening the physical links to the Heritage Park. The Council's investment in the Hall and Park and our consistent adherence to the long term vision published in 2007, when combined with the further protection in emerging DPDs, removes any justification to transfer the ownership and management of the site to a Trust for its protection.
58. In relation to potential financial benefits arising from the running of the Museum and Park by a charitable trust, this scenario has been explored. The potential to use a Trust model to run museums across the Tees Valley was explored by the 5 Tees Valley Authorities in 2010. Based on the integration of at least 3 museums, the analysis showed that costs associated with the establishment and running of a Trust, combined with the considerable costs of transition, were likely to offset all of the efficiency savings and Non-Domestic Rate relief benefits in the short and medium term.

FINANCIAL IMPLICATIONS

59. Funding for the Preston Hall and Park project has been possible through a number of sources, including Heritage Lottery Fund, Esmee Fairbairn Foundation, Playbuilder, Green Museums, Tees Heritage Park and capital funding from Stockton Borough Council.
60. The funding for the Spence Building has been partly through Heritage Lottery Fund, with the remainder expected to be provided from the release of funds from the Spence Bequest.
61. Bids have also been made to Landscapes in Partnership to further develop the Park in two project areas focusing on restoring original features in the planting of the areas around the Hall and on a development of the traditional crafts activities in and around the wider park.
62. A further bid will be made to the Heritage Lottery Fund over the coming months for up to £100,000 for interpretation work to take place on the historic Stockton and Darlington trackbed at the edge of the Park. It may be possible to link this to related bid from the Arts Council to create art installations as part of this work.

LEGAL IMPLICATIONS

63. There are no legal implications to this report as it seeks to update progress on a previously agreed project.

RISK ASSESSMENT

64. "This project is categorised as low risk. Existing management systems and daily routine activities are sufficient to control and reduce risk."

SUSTAINABLE COMMUNITY STRATEGY IMPLICATIONS

Contributes to the following Sustainable Community Strategy themes:

Economic Regeneration and Transport
Culture and Leisure
Children and Young People
Environment and Housing
Healthier Communities and Adults
Older Adults

EQUALITIES IMPACT ASSESSMENT

65. This report is not subject to an Equality Impact Assessment because it provides an update on a previously agreed scheme.

CORPORATE PARENTING

66. Not Applicable.

CONSULTATION INCLUDING WARD/COUNCILLORS

67. Preston Hall Museum & Park (PHM&P) Development Steering Group has overseen the project from its commencement and membership includes representatives from Finance, Planning, Culture and Leisure, Regeneration, Countryside.

68. PHM&P Management and Stakeholder Committee has been fully involved in the process of refurbishment for both the Hall and the Park. The group has representation from the Friends of Preston Park, Tees Heritage Park Initiative, Care for your area, private sector providers, Culture and Leisure and Stockton Borough Council Local Ward Members.

Corporate Director of Development and Neighbourhood Services

Contact Officer **Reuben Kench**

Tel: **01642 527039**

Email Reuben.Kench@stockton.gov.uk

Background Papers

Preston Park Masterplan

Ward(s) and Ward Councillors

None

Property

None

5540 Preston Hall

Ground Floor Concept Plan

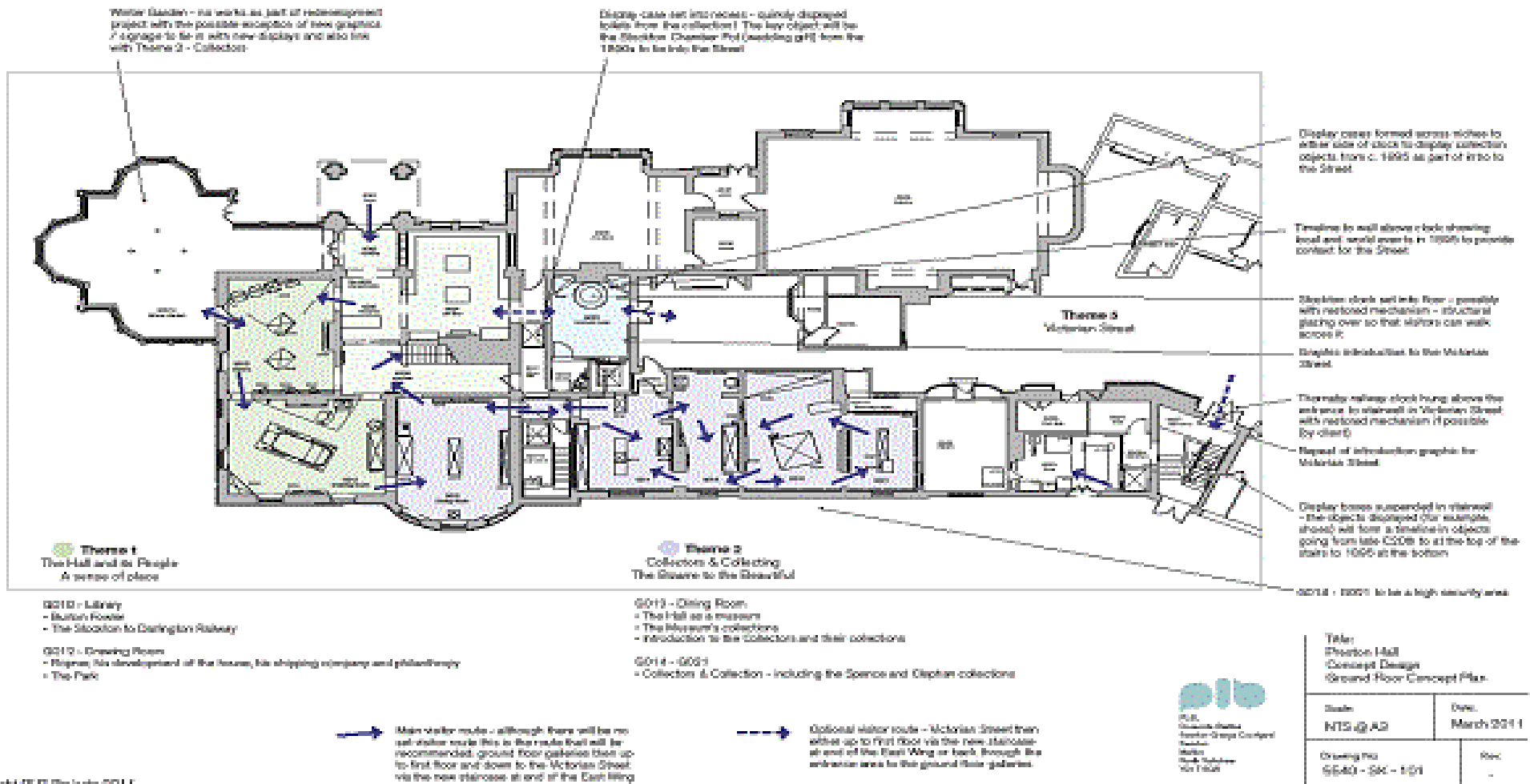

Copyright PUL Projects 2011

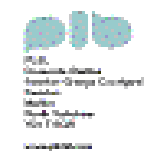

Title Preston Hall Concept Design Ground Floor Concept Plan	
Scale HTS @ A2	Date March 2011
Drawing No 5540 - SAC - 101	Rev -

Throughout the Theme 3 galleries (F104 - F108) the River Tees is referenced in different media, including lighting and materials, paving on floor, ceiling, access display units etc - to create a visual link between the spaces and stories.

Each of the main sub-Themes - Settlement, Industry, Transport, Shipping - will feature object displays covering the archaeology, costume, painting and archive collections as well as the industrial collections.

Large display case featuring objects from different local industries

Interactions bench / children's activities - to be developed based on the objects and related stories

Stained glass mounted in front of window

Display cases for key / iconic objects relating to the settlement of the area throughout the ages

Changeable graphics for Temporary Exhibition Space (F112/F113/F114)

'Rip-away' to show former use of the first floor rooms - above to have clothes on hooks with wash stand and indication of bedroom to walls

Lightweight reproduction of crucible (currently in Orchard) as an iconic object to set the scene for Theme 3 - set against a textured backdrop incorporating an illuminated map of the River Tees which becomes a fine-cut into the floor finish and floor into F108

Niches on stairs could be used for object display - could be visitor curated displays

'Arrivals' and 'Departures' signage to suggest preferred visitor route

Immersive AV featuring archive footage such as the Clocktower and BC material - projected over and incorporating objects - company name plate, signs, posters etc - fixed to the walls

Benches with interactive

Interpretation of the view and the Park around bay window - to be in and make link with Ripper

Display cases formed as shipping crates for objects relating to trade and export, with one lightweight 'crate' suspended above

Model SOH train running around gallery at high level - it will be semi-operated by visitors

Bus stop from collectors to continue the idea of travel - with bench for visitors to sit, including a touch-screen interactive

F105 to become a large display case with lockable glazed doors at both ends of the passageway and feature the 'fashion conveyor' - work-wear from the costume collection displayed on a tracking conveyor. Visitors will be able to operate the conveyor using a touch pad

Large industrial object such as a tiffin on open display against a large-scale photographic backdrop - smaller items will be cased within the open display

Large display case for ship models and other related collection items with touchscreens for information about the objects - models will be displayed suspended from a reconstructed ship's hull within the display case

