

This map is reproduced from Ordnance Survey material with the permission of Ordnance Survey on behalf of the Controller of Her Majesty's Stationary Office. © Crown Copyright. Unauthorised reproduction infringes Crown Copyright and may lead to prosecution or civil proceedings.  
 Stockton-on-Tees Borough Council 100023297

# APPENDIX B

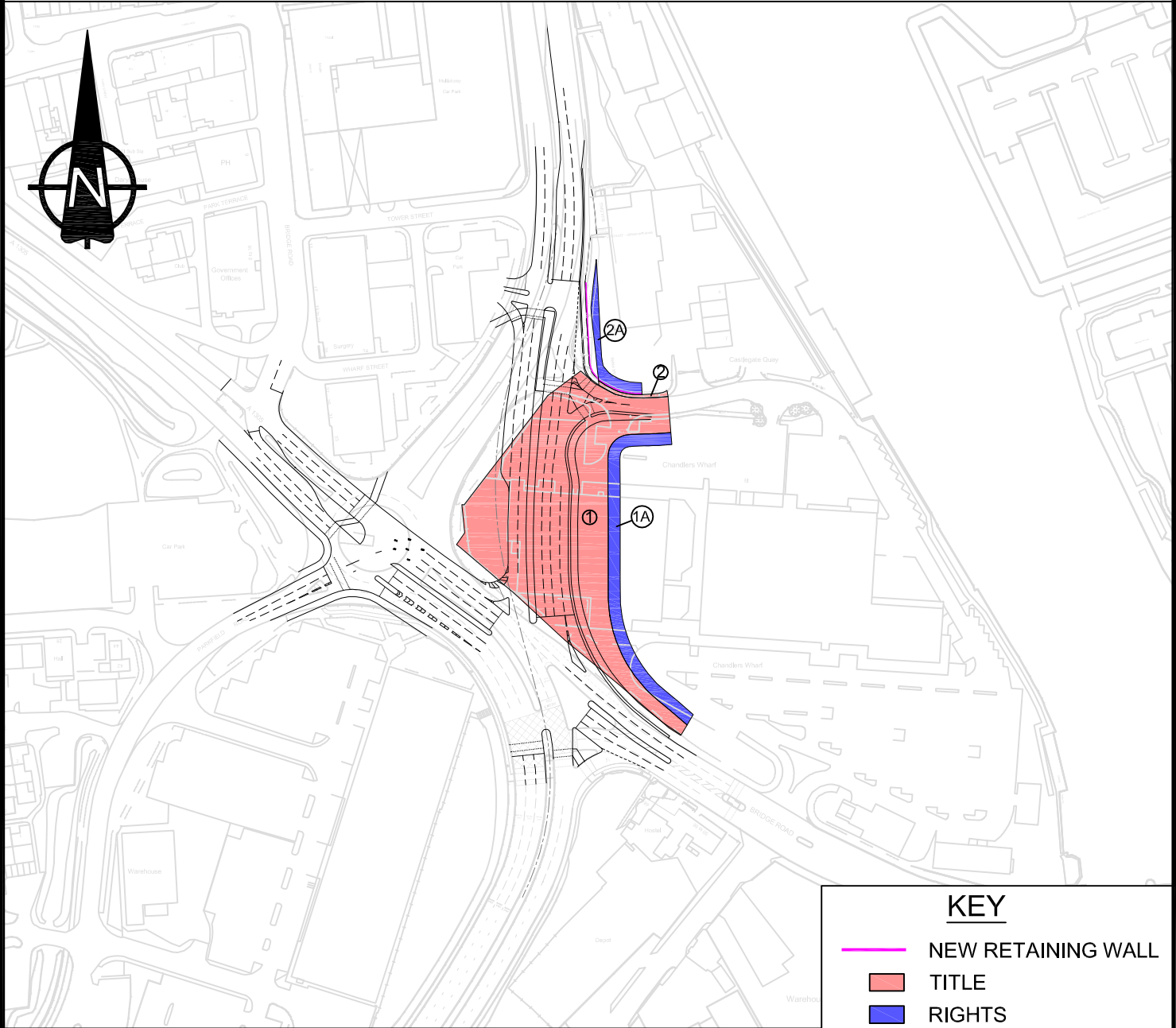

KEY	
	NEW RETAINING WALL
	TITLE
	RIGHTS

Rev	Description	Drm	Chk	Date

Drawing Status    PRELIMINARY     APPROVAL     INFORMATION     TENDER     CONTRACT

**Stockton-on-Tees**  
BOROUGH COUNCIL

Project  
**BRIDGE ROAD/RIVERSIDE IMPROVEMENTS**

Development & Neighbourhood Services  
 Head (Technical Services Division ):Mike Robinson B.Sc., C.Eng., M.I.C.E.  
 P.O.Box 229, Kingsway House, West Precinct, Billingham, TS23 2YL.  
 Telephone (01642) 393939. E-mail: highways@stockton.gov.uk

Content  
**LAND TO BE ACQUIRED**

Scales <b>1:2500</b>	Date <b>AUG '08</b>	Drawn <b>GCF</b> Checked <b>JWS</b>	Job No. <b>TS/D2/69/2/4</b>
-------------------------	------------------------	--	--------------------------------